

Product Information

LC-...HM / HK

**Level Sensor
 LC-...HM / HK**



- Mounted in the cover
- Materials combination may be selected

Characteristics

A float fitted with a magnet affects a chain of reed contacts within the guide tube. The reed contacts are fitted with resistances in such a way that in the very simplest model, behaviour is similar to a potentiometer. The measured value can therefore be evaluated as a resistance value or as a radiometric signal (depending on the supply voltage). Alternatively, a sensor model with 4..20 mA analog output (2 wire or 3 wire) or 0..10 V may be selected. The arrangement of the reed contacts ensures the clarity of the switching state, and therefore a clean detection of the level. Resolution is 10 or 20 mm. The device has high reproducibility.

Technical data

Switch	reed switch chain with float fitted with magnet
Mechanical Connection	LC-S45 G 1 A LC-S44 G 1½ A LC-K52 G2A
For metering ranges, lengths and divisions	see "Ranges, dimensions and weights"
Length tolerance	±5 mm
Pressure resistance	LC-S45 PN 20 bar LC-S44 PN 20 bar LC-K52 PN 40 bar
Medium temperature	-20..+105 °C
Ambient temperature	-20..+70 °C
Storage temperature	-20..+80 °C
Density of medium	LC-S45 ≥ 0.34 g/cm³ LC-S44 ≥ 0.44 g/cm³ LC-K52 ≥ 0.66 g/cm³

Output	resistor chain (radiometric), 4..20 mA or 0..10 V DC
Electrical connection	plug DIN 43650-A / ISO 4400 or for round plug connector M12x1, 4-pole (only for electronic output)
Ingress protection	IP 67
Materials medium-contact	LC-S45 CW614N and Spansil LC-S44 CW614N and Spansil LC-K52 Stainless steel 1.4404
Materials Electronics housing	stainless steel 1.4305
Weights	see table "Ranges, dimensions and weights"
Conformity	CE

Wiring

Reed switch chain Typ WB
 with plug DIN 43650-A / ISO 4400

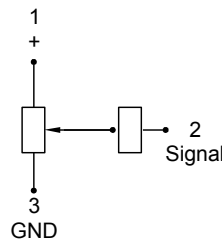

3 wire electronics Typ TS
 for round plug connector M12x1, 4-pole

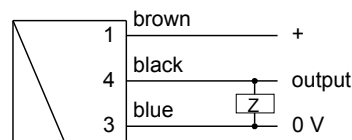

3 wire electronics Typ TB
 with plug DIN 43650-A / ISO 4400

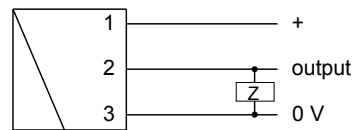

2 wire electronics Typ ZB

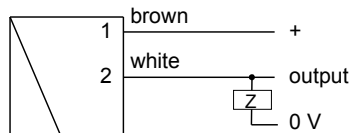

Product Information

LC-...HM / HK

Ranges, dimensions and weights

LC-S45HM

LC-S44HM

LC-K52HK

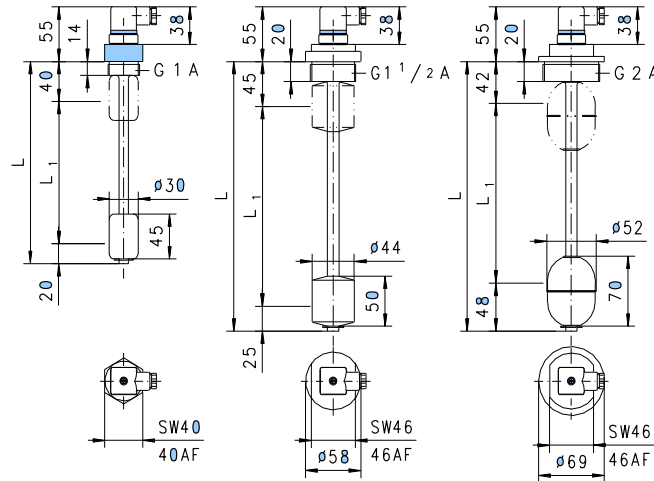

Types LC-	L	L1	Division mm	Resistance * R _{NENN} / Ohm	Tolerance Ohm	Weight kg
S45HM02 50	250	190	10	1800	±136	0.5
S45HM05 00	500	440		4300	±186	0.6
S45HM07 50	750	690		1503	± 52	0.6
S45HM10 00	1000	940		2055	± 64	0.7
S44HM10 00	1000	930	20	2295	± 95	0.7
S44HM15 00	1500	1430		3543	±121	0.8
S44HM20 00	2000	1930		4790	±146	0.8
K52HK02 50	250	160	20	1500	±130	1.0
K52HK05 00	500	410		4000	±280	1.0
K52HK07 50	750	660		1647	± 83	1.0
K52HK10 00	1000	910		2246	± 94	1.1
K52HK15 00	1500	1410		3493	±120	1.1
K52HK20 00	2000	1910		4741	±144	1.1

* + 1000 Ohm
Pre-resistance

Electronic attachments

Round plug connector

Plug
DIN 43650-A / ISO 4400

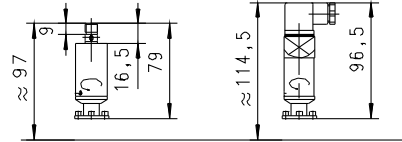

Handling and operation

Note:

Not suitable for use in media with ferritic particles.

Installation

Installation is carried out by screwing the sensor into a suitable threaded drilling on the upper side of the container. A flat seal is included in the scope of the delivery.

Ordering code

LC - 1. 2. 3. 4.

○=Option

1. Version	
S45HM	screw-in fitting G 1 A brass - float Spansil
S44HM	screw-in fitting G 1 1/2 A brass - float Spansil
K52HK	screw-in fitting G 2 A stainless steel
2. Tube length L	
0250	250 mm
0500	500 mm
0750	750 mm
1000	1000 mm
1500	1500 mm
2000	2000 mm
3. Output	
W	resistive sensors
Z	○ 4..20 mA (2 wire)
T	○ 4..20 mA (3 wire)
V	○ 0..10 V
4. Electrical connection	
B	plug DIN 43650-A / ISO 4400
S	○ round plug connector M12x1, 4-pole

Options

- Special lengths,
- Special divisions,
- Temperature 120 °C

Accessories

- Round plug connector/cable